



## PP compression fittings

# "AIR" 90° elbow

### ITEM 550

REFERENCE	DESCRIPTION	Net weight	Volumen (m <sup>3</sup> )	contenido.peso bruto	Unidades lote
112E209	CODO 90° BOCAS IGUALES "AIR" 63-3/4" GRIS	0.975	0.063473	15.525	15
112E210	CODO 90° BOCAS IGUALES "AIR" 63-1" GRIS	0.979	0.063473	15.585	15
112E211	"AIR" 90° ELBOW EQUAL OUTLETS 25-1/2"	0.1545	0.031294	8.285	50
112E212	"AIR" 90° ELBOW EQUAL OUTLETS 25-3/4"	0.145	0.031294	8.06	50
112E213	"AIR" 90° ELBOW EQUAL OUTLETS 32-3/4"	0.216	0.031294	8.12	35
112E214	"AIR" 90° ELBOW EQUAL OUTLETS 32-1"	0.222	0.031294	8.33	35
112E215	"AIR" 90° ELBOW EQUAL OUTLETS 40-3/4"	0.347	0.044603	9.505	25
112E216	"AIR" 90° ELBOW EQUAL OUTLETS 40-1"	0.352	0.044603	9.63	25
112E217	"AIR" 90° ELBOW EQUAL OUTLETS 50-3/4"	0.55	0.044603	9.08	15
112E218	"AIR" 90° ELBOW EQUAL OUTLETS 50-1"	0.556	0.044603	9.17	15



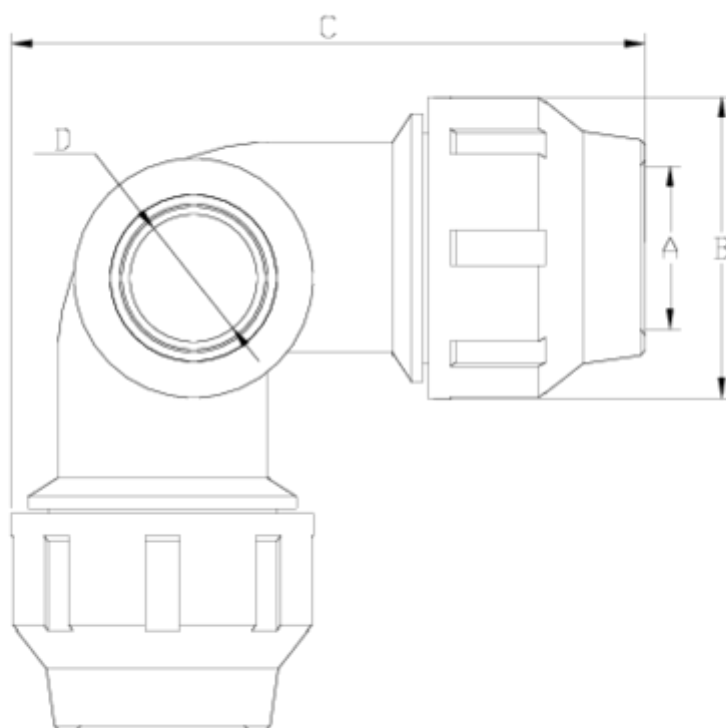

## ITEM 550 | "AIR" 90° elbow

Código	f tubo - D	Peso (g)	A	B	C	PN	MEDIDA
12E211	25 - 1/2"	147	26	55	115	PN16	BSP
12E212	25 - 3/4"	152	26	55	115	PN16	BSP
12E213	32 - 3/4"	216	33	64	132	PN16	BSP
12E214	32 - 1"	222	33	64	132	PN16	BSP
12E215	40 - 3/4"	347	42	76	155	PN16	BSP
12E216	40 - 1"	352	42	76	155	PN16	BSP
12E217	50 - 3/4"	550	51	91	173	PN16	BSP
12E218	50 - 1"	556	51	91	173	PN16	BSP
12E209	63 - 3/4"	955	64	109	205	PN16	BSP
12E210	63 - 1"	945	64	109	205	PN16	BSP





## ITEM 550 | "AIR" 90° elbow

---



## Product Documents



## Product Certificates

## Company Certificates

