



PP compression fittings

Straight union, female threaded

ITEM 477



REFERENCE	DESCRIPTION	Net weight	Volumen (m ³)	contenido.peso bruto	Unidades lote
112E046	COUPLING,FEMALE THREAD 20-1/2" GREY	0.052	0.022435	5.74	100
112E047	COUPLING,FEMALE THREAD 25-3/4" GREY	0.081	0.031294	8.66	100
112E048	COUPLING,FEMALE THREAD 32-1" GREY	0.120651	0.044603	12.795	100
112E049	COUPLING,FEMALE THREAD 40-1-1/4" GREY	0.213	0.044603	12.758	56
112E050	COUPLING,FEMALE THREAD 50-1 1/2" GREY	0.31248	0.044603	13.165	40
112E051	COUPLING,FEMALE THREAD 63-2" GREY	0.551	0.061499	16.408	28
112E053	ENLACE RECTO M/HEMBRA 25-1/2" GRIS	0.085	0.03129	9.073	100
112E055	ENLACE RECTO M/HEMBRA 32-3/4" GRIS	0.125	0.0446	13.23	100

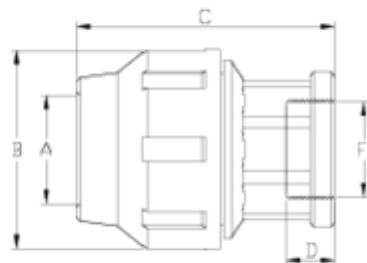

ITEM 477 | Straight union, female threaded

Código	f tubo	Peso (g)	A	B	C	D	PN	TIPO ROSCA
12E046	20 - 1/2"	54	21	46	75	18	PN16	BSP
12E053	25 - 1/2"	82	26	55	83	18	PN16	BSP
12E047	25 - 3/4"	79	26	55	83	21	PN16	BSP
12E055	32 - 3/4"	122	33	63	92	21	PN16	BSP
12E048	32 - 1"	117	33	63	92	23	PN16	BSP
12E049	40 - 1 1/4"	196	42	76	111	25	PN16	BSP
12E050	50 - 1 1/2"	289	51	91	118	25	PN16	BSP
12E051	63 - 2"	509	64	109	140	29	PN16	BSP
12E144	75 - 2 1/2"	902	77	133	169	34	PN10	BSP
12E145	90 - 3"	1494	92	159	204	38	PN10	BSP



ITEM 477 | Straight union, female threaded

12E146

110 - 4"

2064

112

183

231

50

PN10

BSP



Product Documents



Product Certificates

Company Certificates

