



## 'Compact' ball valves

# Female threaded - FPM seal

## ITEM 718

REFERENCE	DESCRIPTION	Net weight	Volumen (m <sup>3</sup> )	Gross weight	Unidades lote
111C100	COMPACT VALVE FEMALE THR.1/2" FPM	0.106	0.008918	2.336	20
111C101	COMPACT VALVE FEMALE THR.3/4" FPM	0.13813	0.008918	2.95	20
111C102	COMPACT VALVE FEMALE THR.1" FPM	0.1976	0.015532	3.291	15
111C103	COMPACT VALVE FEMALE THR.1 1/4" FPM	0.313	0.015532	5.9967	15
111C104	COMPACT VALVE FEMALE THR.1 1/2" FPM	0.459	0.015532	6.25	10
111C105	COMPACT VALVE FEMALE THR.2" FPM	0.8255	0.015532	4.454	5
111C106	VALVULA COMPACT R/HEMBRA 2 1/2" FPM	1.63	0.01553	3.832	2
111C107	VALVULA COMPACT R/HEMBRA 3" FPM	1.644	0.01553	3.712	2



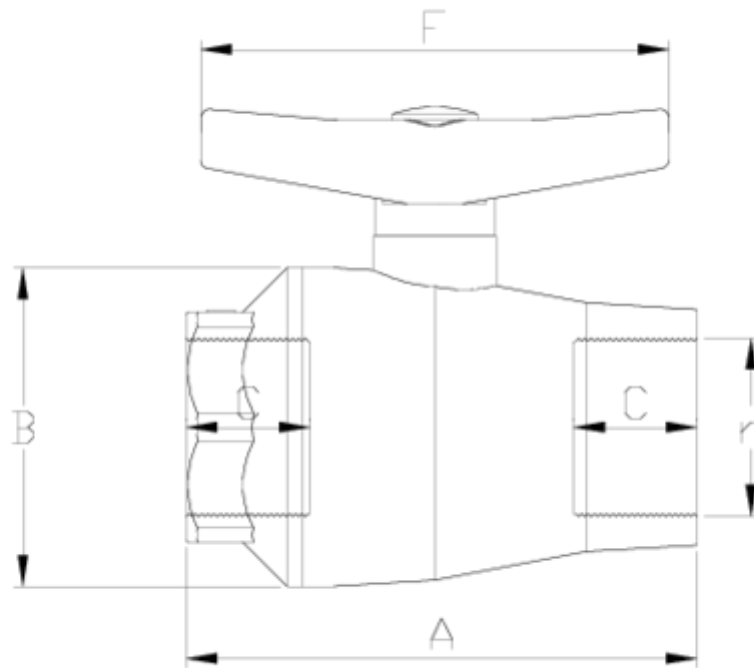

## ITEM 718 | Female threaded - FPM seal

CODIGO	r	DN	PESO (g)	A	B	C	F	PN	TIPO ROSCA
11C100	1/2"	15	107.8	82	48	17	80	PN16	BSP
11C101	3/4"	20	135.8	89	53	20	80	PN16	BSP
11C102	1"	25	220.5	101	59	23	101	PN16	BSP
11C103	1 1/4"	32	378	117	69	26	130	PN16	BSP
11C104	1 1/2"	40	571.2	141	83	33	130	PN16	BSP
11C105	2"	50	912.8	162	104	39	172	PN16	BSP
11C106	2 1/2"	65	1765	188	132	34	265	PN10	BSP
11C107	3"	65	1615	188	132	35	265	PN10	BSP



## Product Documents



## Product Certificates

## Company Certificates

