



## 'Compact' ball valves

# Female threaded - PTFE seal ITEM 566

REFERENCE	DESCRIPTION	Net weight	Volumen (m <sup>3</sup> )	Gross weight	Unidades lote
111C000	GFPP COMP.B.V.1/2" F/THREADED END	0.10863	0.008918	2.36	20
111C001	GFPP COMP.B.V.3/4" F/THREADED END	0.13138	0.008918	2.865	20
111C002	GFPP COMP.B.V.1" F/THREADED END	0.19672	0.015532	3.252	15
111C003	GFPP COMP.B.V.1 1/4" F/THREADED END	0.313153	0.022435	5.185	15
111C004	GFPP COMP.B.V.1 1/2" F/THREADED END	0.45883	0.015532	4.915	10
111C005	GFPP COMP.B.V.2" F/THREADED END	0.82066	0.015532	4.43	5
111C006	GFPP COMP.B.V.2 1/2" F/THREADED END	1.7506	0.01553	3.828	2
111C007	GFPP COMP.B.V. 3" F/THREADED END	1.6442	0.01553	3.615	2



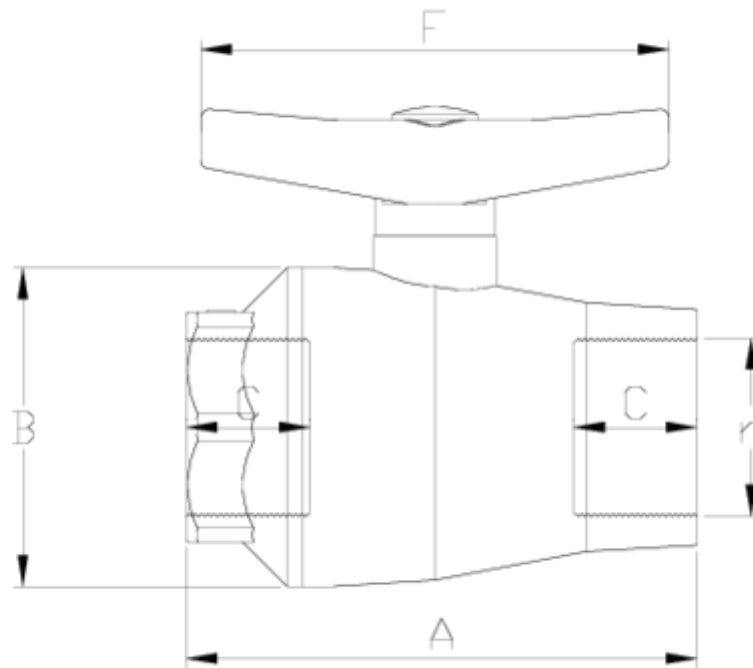

## ITEM 566 | Female threaded - PTFE seal

CODIGO	r	DN	PESO (g)	A	B	C	F	PN	TIPO ROSCA
11C000	1/2"	15	107.8	82	48	17	80	PN16	BSP
11C001	3/4"	20	135.8	89	53	20	80	PN16	BSP
11C002	1"	25	220.5	101	59	23	101	PN16	BSP
11C003	1 1/4"	32	378	117	69	26	130	PN16	BSP
11C004	1 1/2"	40	571.2	141	83	33	130	PN16	BSP
11C005	2"	50	912.8	162	104	39	172	PN16	BSP
11C006	2 1/2"	65	1765	188	132	34	265	PN10	BSP
11C007	3"	65	1615	188	132	35	265	PN10	BSP



## Product Documents



## Product Certificates

## Company Certificates

