



Ventosas Net®

Doble Efecto (C1) PA

ITEM 306

REFERÊNCIA	DESCRIÇÃO	Peso líquido	Volume (m ³)	contenido.peso bruto	Unidades por lote
1017001	VENTOSA DOBLE EFECTO PPFV 1/2"	0.284	0.02244	6.17	20
1017002	VENTOSA NET DOBLE EFECTO E/CINETICO 3/4"(PPFV)	0.289	0.02244	6.27	20
1017003	VENTOSA NET E/CINETICO 1"(PPFV)	0.283	0.02244	6.15	20
1017501	VENTOSA NET E/CINETICO 1/2"(PA)	0.285	0.02244	6.24	20
1017502	VENTOSA NET E/CINETICO 3/4"(PA)	0.289	0.02244	6.32	20
1017503	VENTOSA NET E/CINETICO 1"(PA)	0.289	0.02244	6.27	20

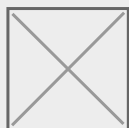

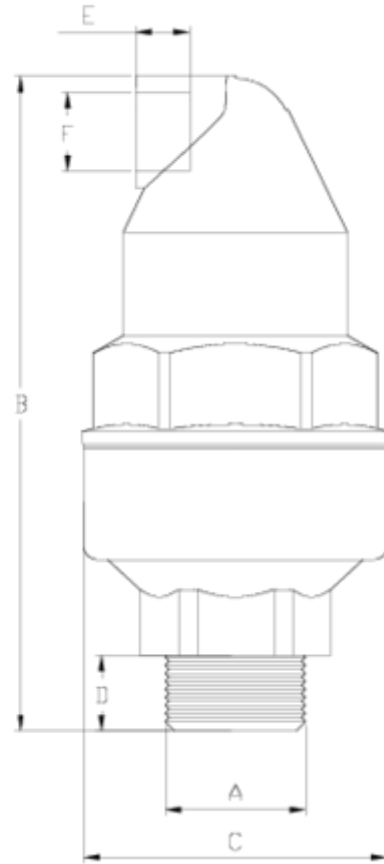

ITEM 306 | Doble Efecto (C1) PA

Código	f A	Peso (g)	B	C	D	E	F	Material	PN	TIPO ROSCA
17001	1/2"	256.5	158	75	14	15	1/2"	PPFV	PN16	BSP
17002	3/4"	260.1	160	75	16	15	1/2"	PPFV	PN16	BSP
17003	1"	265.5	163	75	19	15	1/2"	PPFV	PN16	BSP
17501	1/2"	281.2	158	75	14	15	1/2"	PA	PN25	BSP
17502	3/4"	285.95	160	75	16	15	1/2"	PA	PN25	BSP
17503	1"	291.65	163	75	19	15	1/2"	PA	PN25	BSP

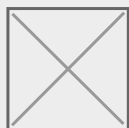



Documentação do Produto



Certificados do Produto

Certificados da Empresa

