



PVC-U pressure fittings

Reinforced plain F/T 45° elbow

ITEM 434

| REFERÊNCIA | DESCRIÇÃO | Peso líquido | Volume (m ³) | contenido.peso bruto | Unidades por lote |
|------------|--------------------------------|--------------|--------------------------|----------------------|-------------------|
| 1002170 | CODO 45° ENC/R-H REF 20-1/2" | 0.021 | 0.00473 | 2.22 | 100 |
| 1002171 | CODO 45° ENC/R-H REF 25-3/4" | 0.039 | 0.00892 | 4.04 | 100 |
| 1002172 | CODO 45° ENC/R-H REF 32-1" | 0.065 | 0.01553 | 6.74 | 100 |
| 1002173 | CODO 45° ENC/R-H REF 40-1 1/4" | 0.103 | 0.03129 | 11.85 | 110 |
| 1002174 | CODO 45° ENC/R-H REF 50-1 1/2" | 0.149 | 0.04717 | 17.15 | 110 |
| 1002175 | CODO 45° ENC/R-H REF 63-2" | 0.259 | 0.04717 | 15.01 | 55 |
| 1002176 | CODO 45° ENC-R/H REF 75-2 1/2" | 0.393 | 0.04117 | 13.66 | 33 |
| 1002177 | CODO 45° ENC-R/H REF 90-3" | 0.683 | 0.04117 | 11.62 | 16 |

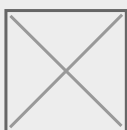

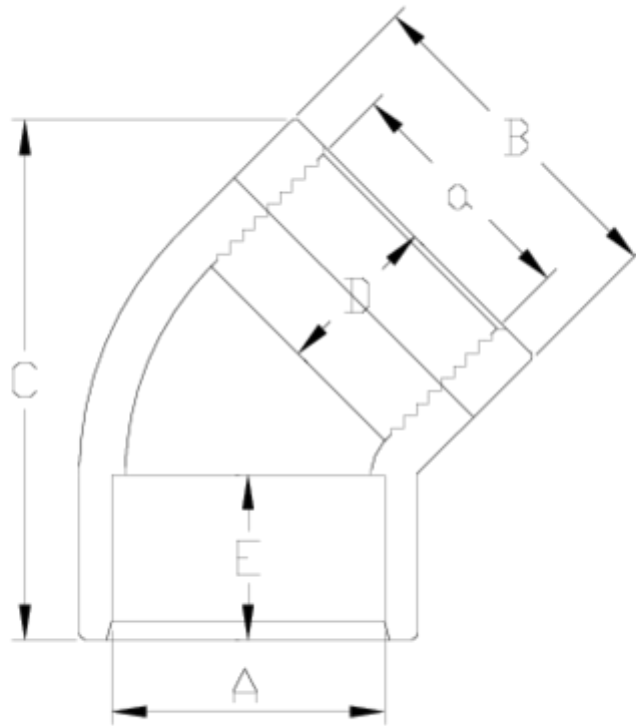

ITEM 434 | Reinforced plain F/T 45° elbow

| Código | A-a | Peso (g) | B | C | D | E | PN | ROSCA |
|--------|-----------|----------|-----|-----|----|----|------|-------|
| 02170 | 20-1/2" | 28 | 27 | 48 | 16 | 16 | PN10 | BSP |
| 02171 | 25-3/4" | 39 | 33 | 53 | 19 | 17 | PN10 | BSP |
| 02172 | 32-1" | 65 | 41 | 63 | 22 | 21 | PN10 | BSP |
| 02173 | 40-1 1/4" | 89 | 50 | 80 | 26 | 23 | PN10 | BSP |
| 02174 | 50-1 1/2" | 149 | 61 | 95 | 31 | 24 | PN10 | BSP |
| 02175 | 63-2" | 259 | 75 | 125 | 38 | 28 | PN10 | BSP |
| 02176 | 75-2 1/2" | 393 | 89 | 140 | 45 | 32 | PN10 | BSP |
| 02177 | 90-3" | 683 | 107 | 162 | 51 | 35 | PN10 | BSP |

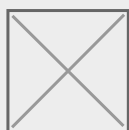



Documentación del Producto



Certificados del Producto

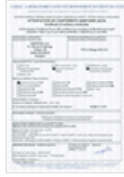

Certificados de la Empresa

